

# West Burton Solar Project

## Public Rights of Way Plan

Prepared by: Lanpro Services  
March 2023

PINS reference: EN010132  
Document reference: APP/WB2.4  
APFP Regulation 5(2)(k)





- Key**
- Order Limits
  - Sheet Index
  - Potential PROW Diversion Area
  - Public Right of Way (PROW)
  - Footpath
  - Bridleway
  - Byway
  - Byway Open to All Traffic
  - PROW to be temporarily stopped up
  - Byway Open to All Traffic
  - Bridleway
  - Byway
  - Footpath

Layers: Lincolnshire County Council, 2023; Nottinghamshire County Council, 2023; North Lincolnshire County Council, 2023; Lanpro, 2023; ISD, 2023  
 Base map: Reproduced from Ordnance Survey digital map data © Crown copyright 2023. All rights reserved. License number 0100031673

0 1 2 Kilometres

Scale: 1:17,500@A0

APPP Regulation: 5(2)(k)	Application Doc No. WB2.4
Ref: P2983_LPR_ZZ_ON_DR_Z_0209	Date: 07/03/2023
Drawn by: AZ	Checked by: ID

**Public Rights of Way Plan**  
Index Sheet

**WEST BURTON SOLAR PROJECT**

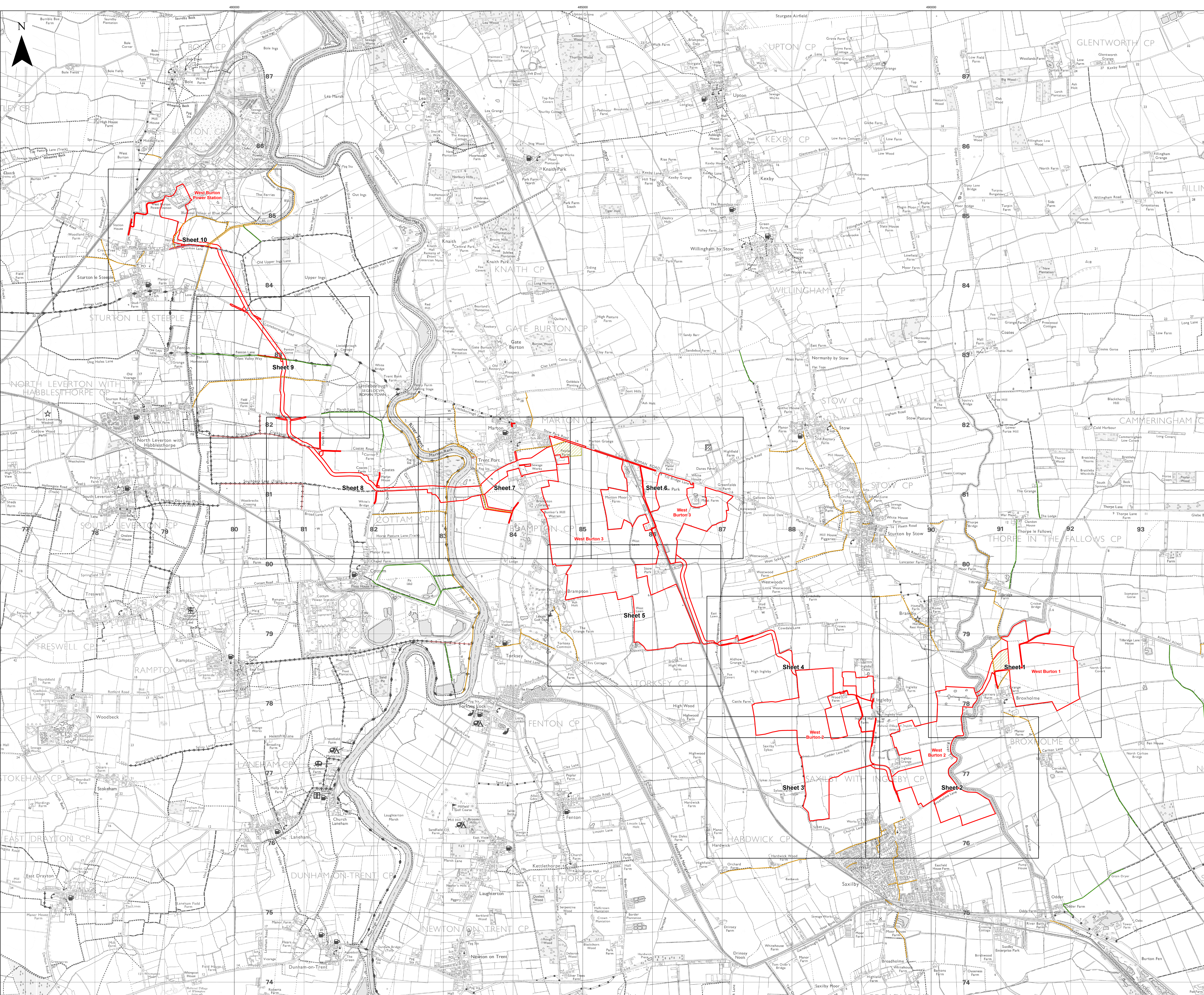



- Key**
- Order Limits
  - Sheet Index
  - Civil Parish Boundary
  - Potential PRoW Diversion Area
  - Public Right of Way (PRoW)**
  - Footpath
  - PRoW to be temporarily stopped up
  - Footpath
  - PRoW to be temporarily stopped up - start and end points
  - Footpath

Layers: Lincolnshire County Council, 2023; Nottinghamshire County Council, 2023; North Lincolnshire County Council, 2023; Lanpro, 2023; IGR, 2023  
Base map: reproduced from Ordnance Survey digital map data © Crown copyright 2023. All rights reserved. License number 0100031673

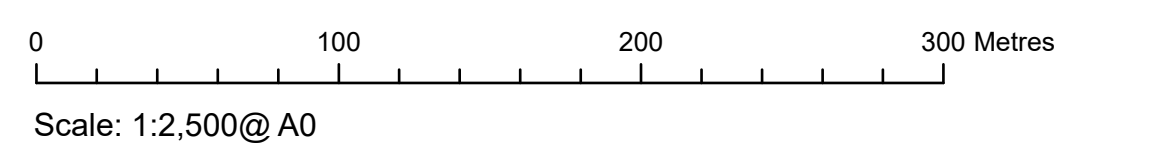

APFP Regulation: 5(2)(k)	Application Doc No. WB2.4
Ref: P2963_LPR_ZZ_ON_DR_Z_0210	Date: 07/03/2023
Drawn by: AZ	Checked by: ID

**Public Rights of Way Plan**  
Sheet 1 of 10

**WEST BURTON SOLAR PROJECT**

For continuation refer to sheet 2

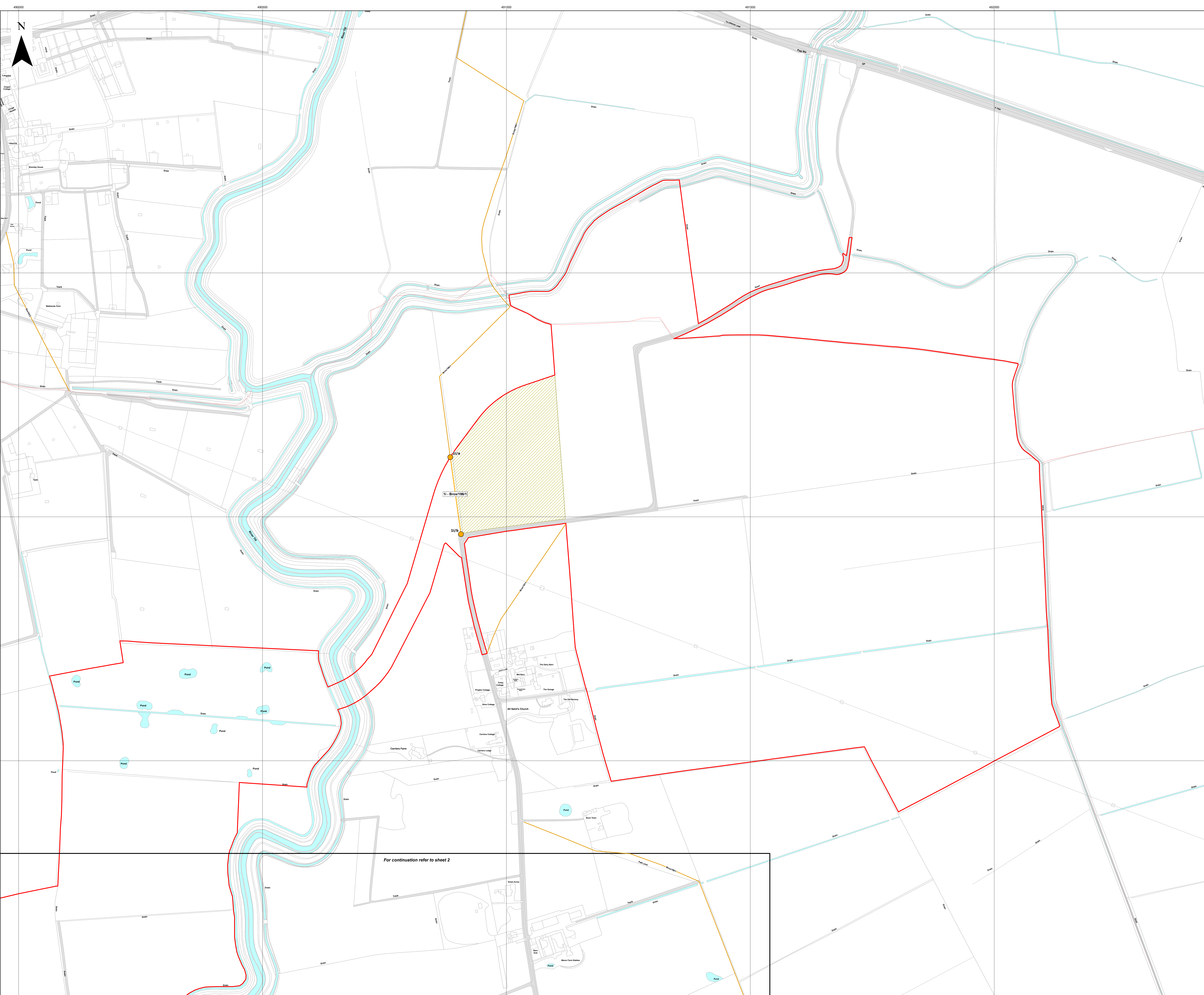



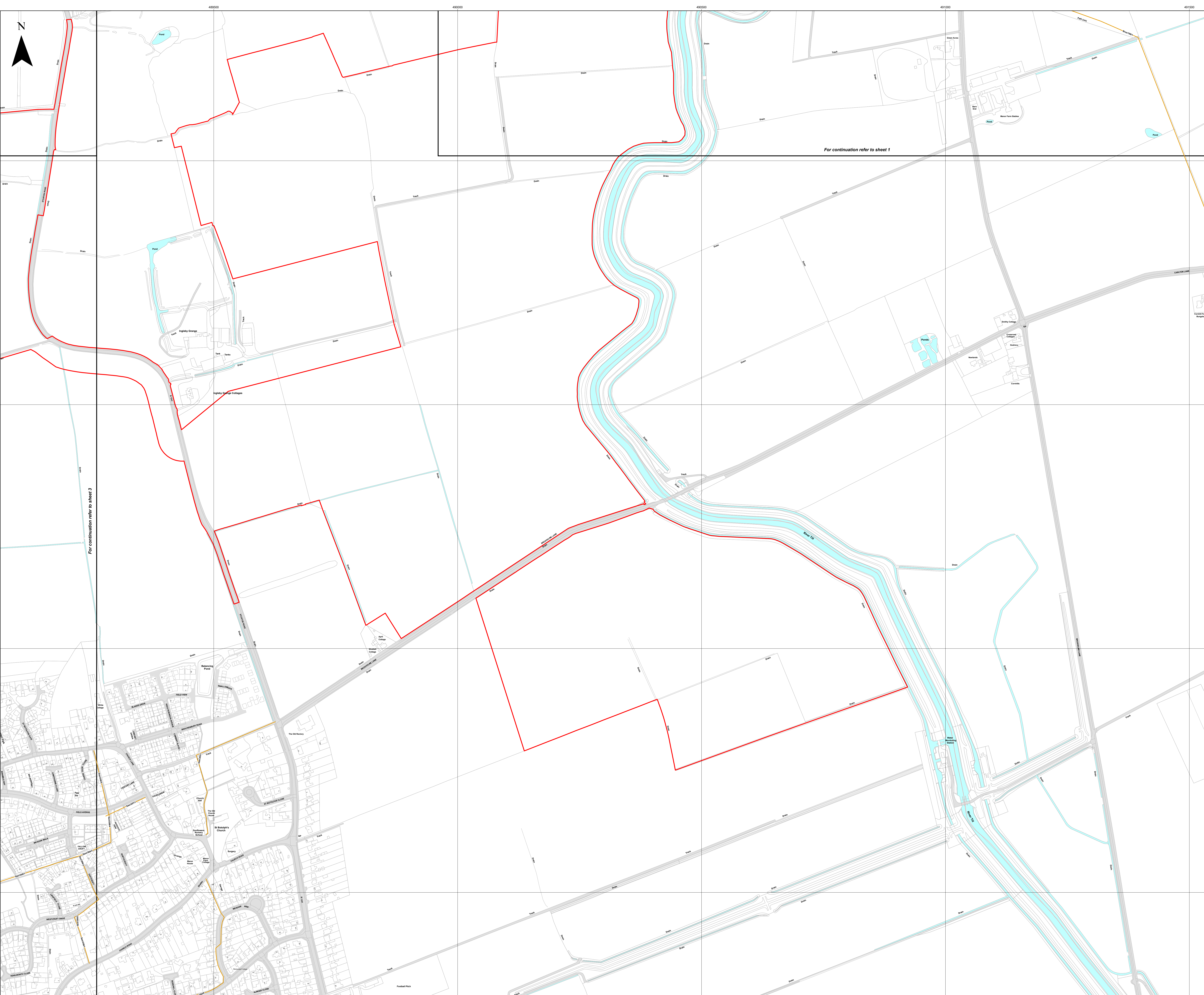

- Key**
- Order Limits
  - Sheet Index
  - Civil Parish Boundary
  - Potential PRow Diversion Area
  - Public Right of Way (PRow)
  - Footpath

For continuation refer to sheet 1

For continuation refer to sheet 3

Layers: Lincolnshire County Council, 2023; Nottinghamshire County Council, 2023; North Lincolnshire County Council, 2023; Lanpro, 2023; IGR, 2023  
Base map: reproduced from Ordnance Survey digital map data © Crown copyright 2023. All rights reserved. License number 0100031673



APFP Regulation: 5(2)(k)	Application Doc No. WB2.4
Ref: P2963_LPR_ZZ_ON_DR_Z_0210	Date: 07/03/2023
Drawn by: AZ	Checked by: ID

**Public Rights of Way Plan**  
Sheet 2 of 10

**WEST BURTON SOLAR PROJECT**







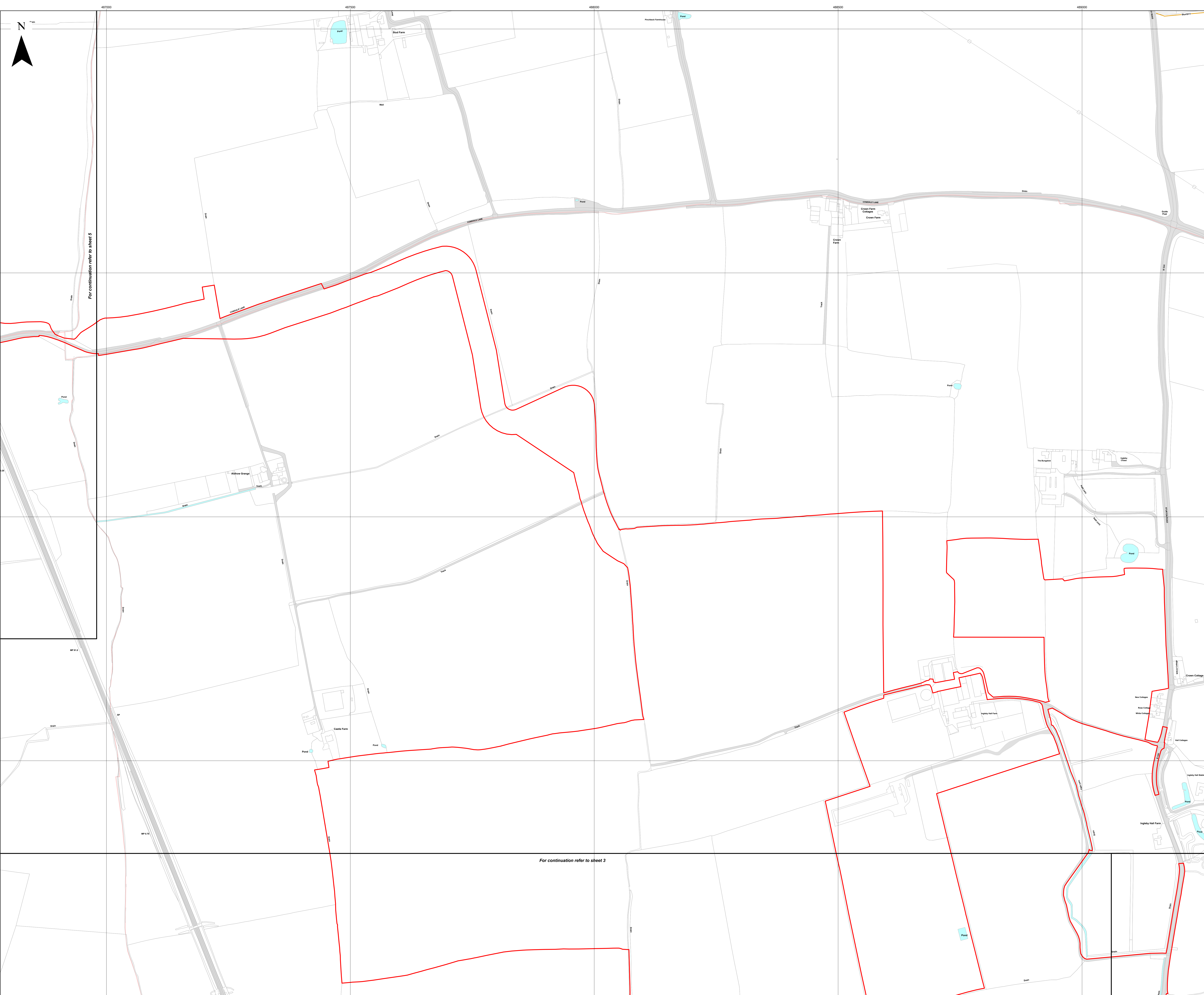

- Key**
- Order Limits
  - Sheet Index
  - Civil Parish Boundary
  - Potential PRow Diversion Area
  - Public Right of Way (PRow)
  - Footpath

For continuation refer to sheet 5

For continuation refer to sheet 3

Layers: Lincolnshire County Council, 2023; Nottinghamshire County Council, 2023; North Lincolnshire County Council, 2023; Lanpro, 2023; IGR, 2023  
Base map: reproduced from Ordnance Survey digital map data © Crown copyright 2023. All rights reserved. License number 0100031673

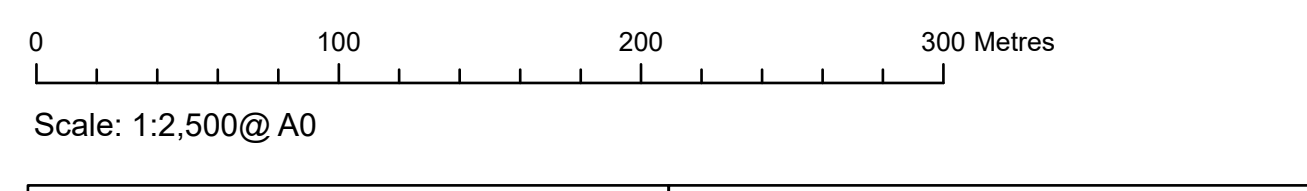

APFP Regulation: 5(2)(k)	Application Doc No. WB2.4
Ref: P2963_LPR_ZZ_ON_DR_Z_0210	Date: 07/03/2023
Drawn by: AZ	Checked by: ID

**Public Rights of Way Plan**  
Sheet 4 of 10

**WEST BURTON SOLAR PROJECT**



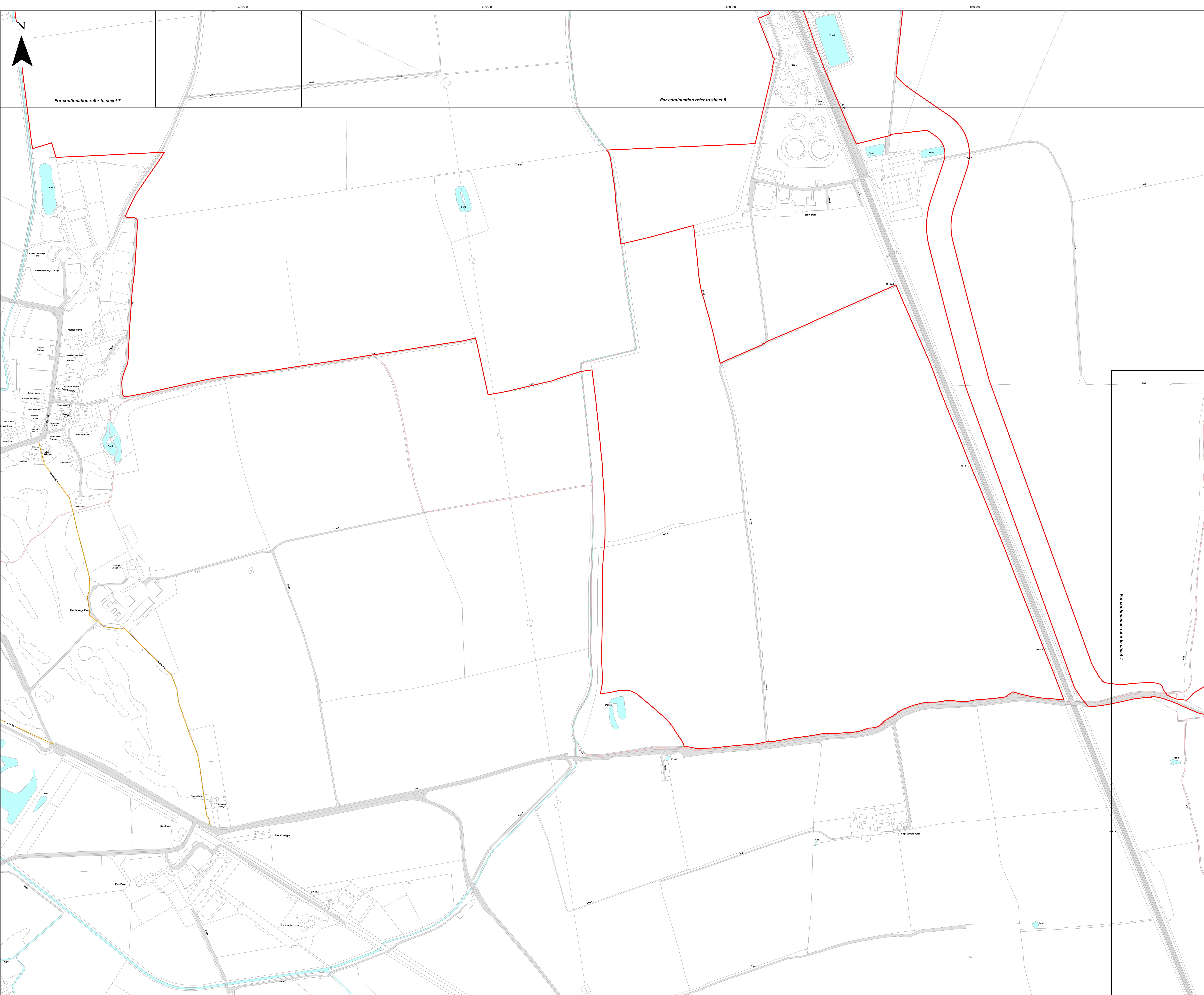

For continuation refer to sheet 7

For continuation refer to sheet 6

For continuation refer to sheet 4



- Key**
- Order Limits
  - Sheet Index
  - Civil Parish Boundary
  - Potential PRow Diversion Area
  - Public Right of Way (PRow)
  - Footpath

Layers: Lincolnshire County Council, 2023; Nottinghamshire County Council, 2023; North Lincolnshire County Council, 2023; Lanpro, 2023; IGR, 2023  
 Base map: reproduced from Ordnance Survey digital map data © Crown copyright 2023. All rights reserved. License number 0100031673

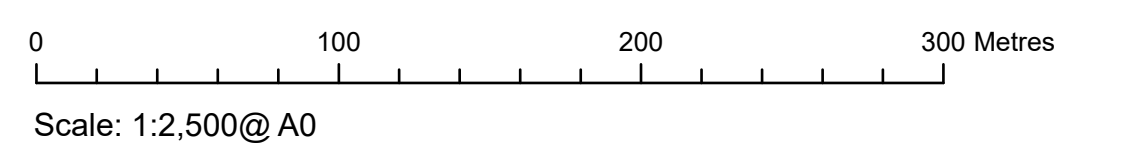

APFP Regulation: 5(2)(k)	Application Doc No. WB2.4
Ref: P2963_LPR_ZZ_ON_DR_Z_0210	Date: 07/03/2023
Drawn by: AZ	Checked by: ID

**Public Rights of Way Plan**  
Sheet 5 of 10

**WEST BURTON SOLAR PROJECT**



- Key**
- Order Limits
  - Sheet Index
  - Civil Parish Boundary
  - Potential PtO/W Diversion Area

Layers: Lincolnshire County Council, 2023; Nottinghamshire County Council, 2023; North Lincolnshire County Council, 2023; Lanpro, 2023; IGR, 2023  
Base map: reproduced from Ordnance Survey digital map data © Crown copyright 2023. All rights reserved. License number 0100031673



Scale: 1:2,500@ A0

APFP Regulation: 5(2)(k)	Application Doc No. WB2.4
Ref: P2963_LPR_ZZ_ON_DR_Z_0210	Date: 07/03/2023
Drawn by: AZ	Checked by: ID

**Public Rights of Way Plan**  
Sheet 6 of 10

**WEST BURTON SOLAR PROJECT**

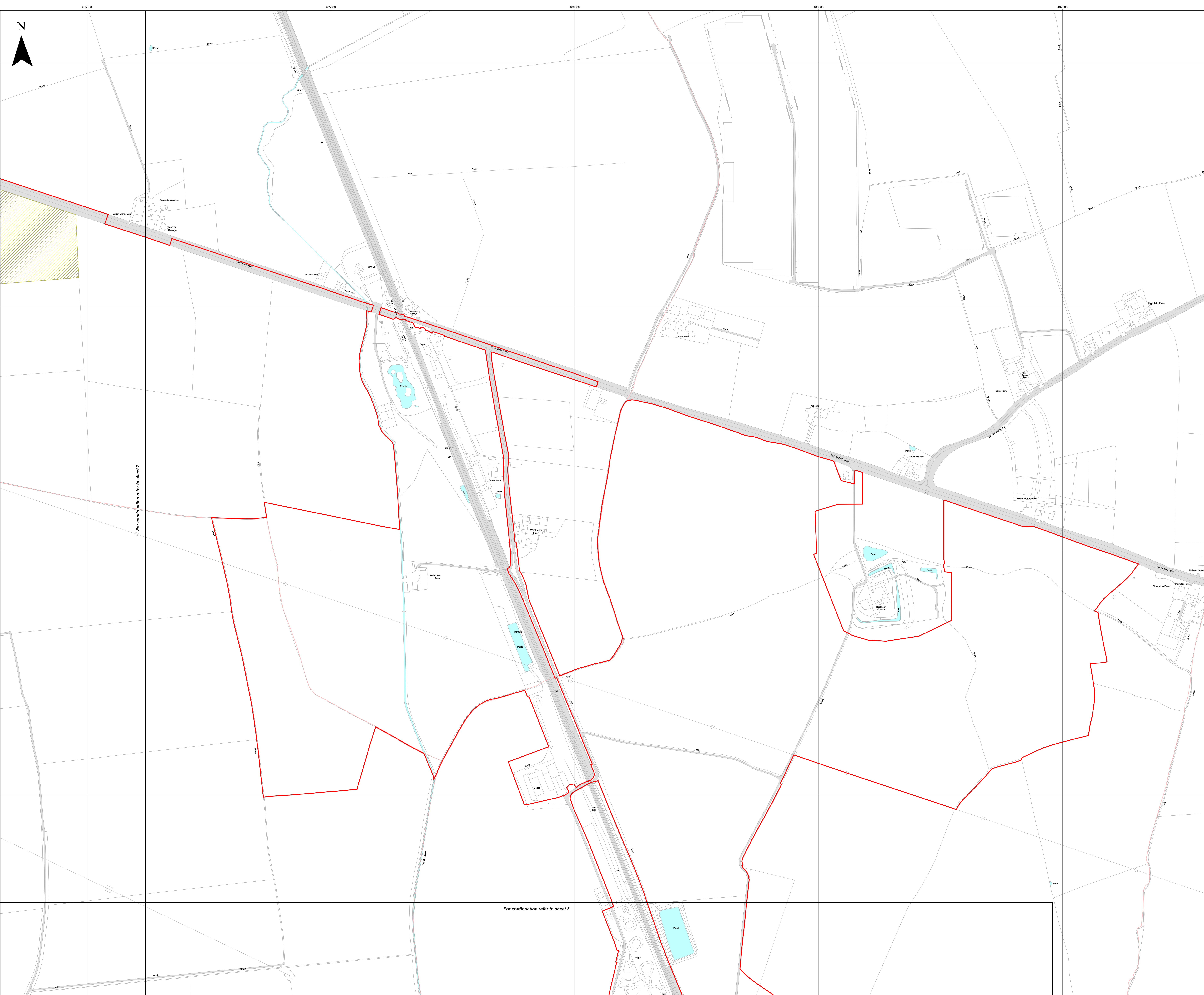

For continuation refer to sheet 7

For continuation refer to sheet 5







- Key**
- Order Limits
  - Sheet Index
  - Civil Parish Boundary
  - Potential PRoW Diversion Area
  - Public Right of Way (PRoW)**
  - Footpath
  - Bridleway
  - Byway Open to All Traffic
  - PRoW to be temporarily stopped up**
  - Byway Open to All Traffic
  - Byway
  - PRoW to be temporarily stopped up - start and end points**
  - Byway
  - BOAT

Layers: Lincolnshire County Council, 2023; Nottinghamshire County Council, 2023; North Lincolnshire County Council, 2023; Lanpro, 2023; IGR, 2023  
Base map: reproduced from Ordnance Survey digital map data © Crown copyright 2023. All rights reserved. License number 0100031673



APFP Regulation: 5(2)(k)	Application Doc No. WB2.4
Ref: P2963_LPR_ZZ_ON_DR_Z_0210	Date: 07/03/2023
Drawn by: AZ	Checked by: ID

**Public Rights of Way Plan**  
Sheet 8 of 10

**WEST BURTON SOLAR PROJECT**

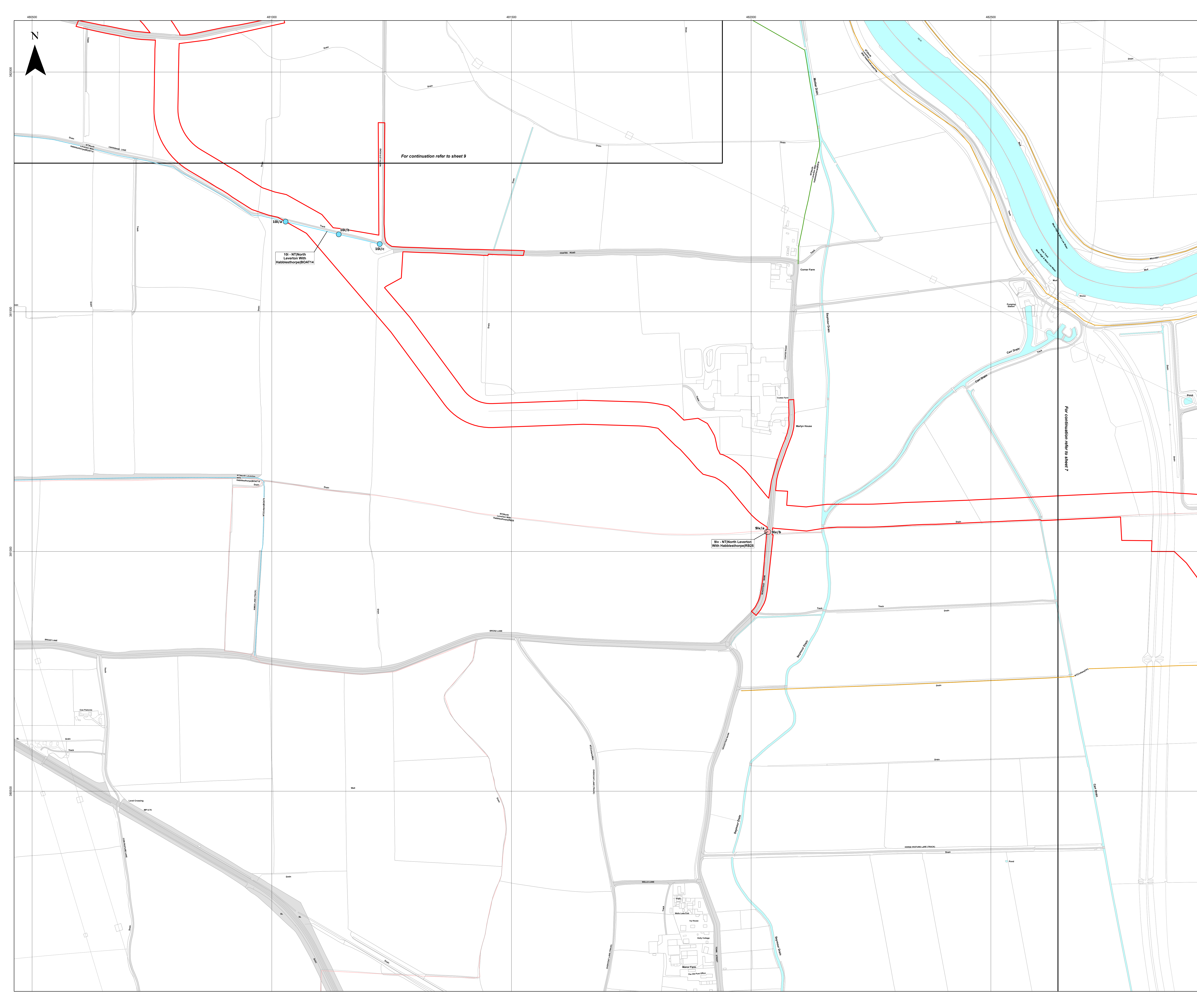



- Key**
- Order Limits
  - Sheet Index
  - Civil Parish Boundary
  - Potential PRoW Diversion Area
  - Public Right of Way (PRoW)**
  - Footpath
  - Bridleway
  - Byway Open to All Traffic
  - PRoW to be temporarily stopped up**
  - Bridleway
  - Byway
  - Footpath
  - PRoW to be temporarily stopped up - start and end points**
  - Footpath
  - Bridleway
  - Byway

Layers: Lincolnshire County Council, 2023; Nottinghamshire County Council, 2023; North Lincolnshire County Council, 2023; Lanpro, 2023; IGR, 2023  
Base map: reproduced from Ordnance Survey digital map data © Crown copyright 2023. All rights reserved. License number 0100031673

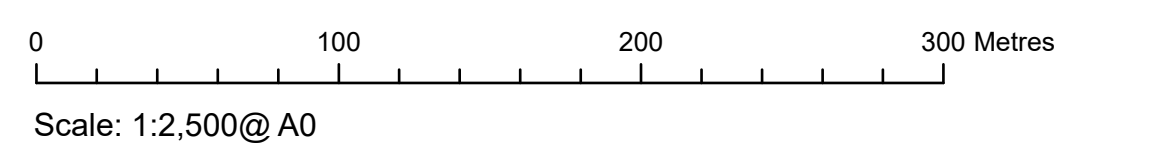

APFP Regulation: 5(2)(k)	Application Doc No. WB2.4
Ref: P2963_LPR_ZZ_ON_DR_Z_0210	Date: 07/03/2023
Drawn by: AZ	Checked by: ID

**Public Rights of Way Plan**  
Sheet 9 of 10

**WEST BURTON SOLAR PROJECT**

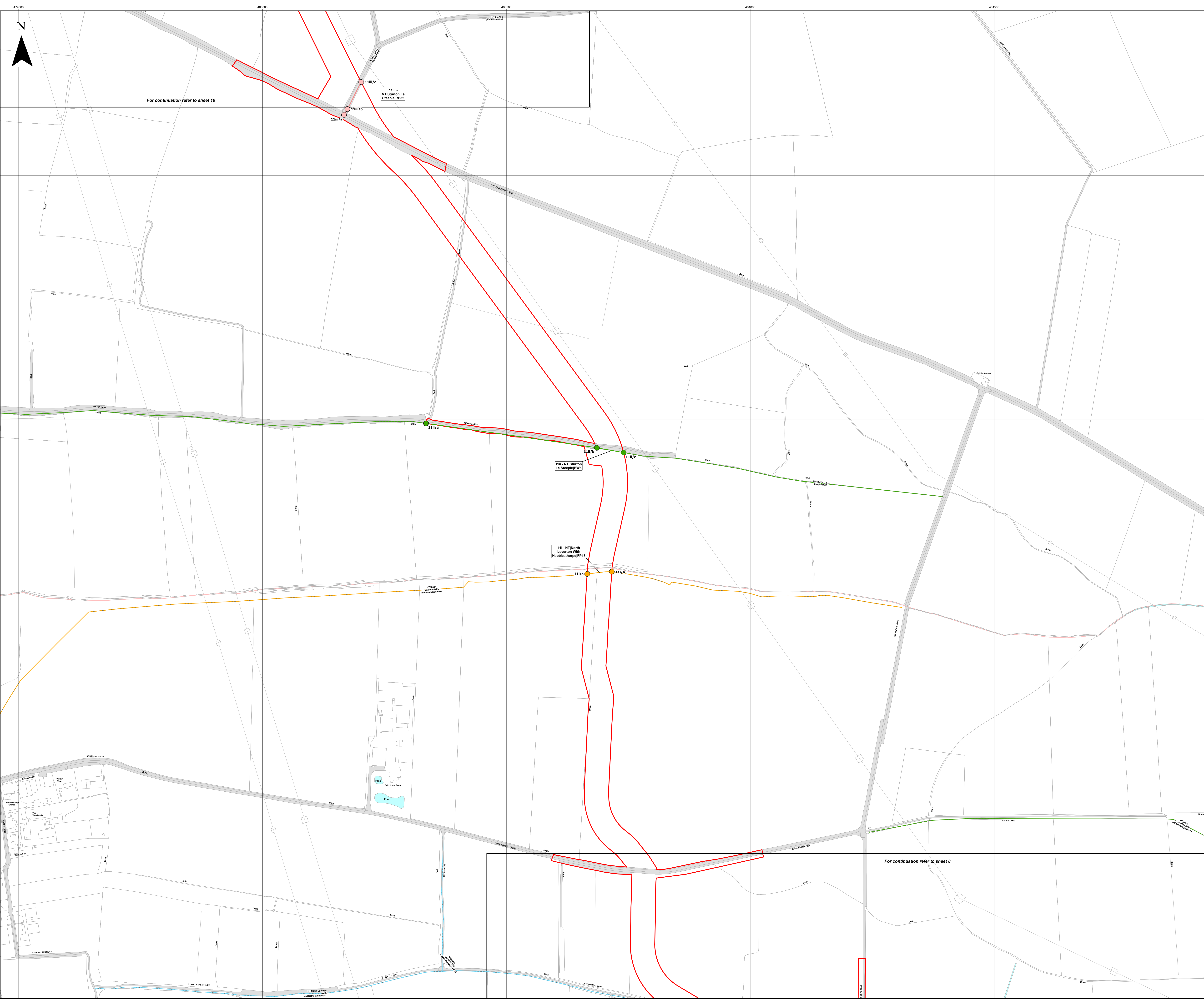



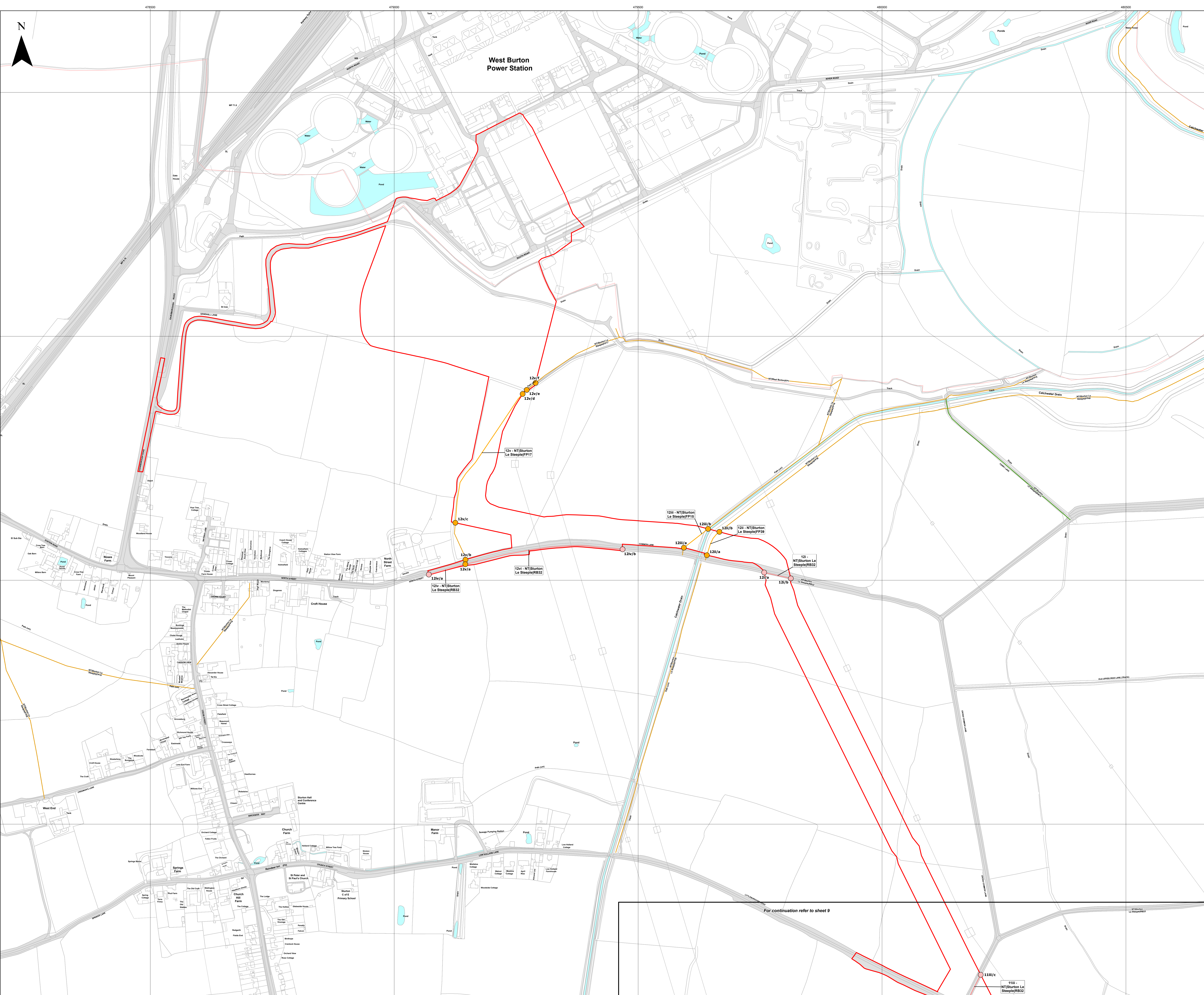

- Key**
- Order Limits
  - Sheet Index
  - Civil Parish Boundary
  - Potential PROW Diversion Area
  - Public Right of Way (PROW)**
  - Footpath
  - Bridleway
  - PROW to be temporarily stopped up**
  - Byway
  - Footpath
  - PROW to be temporarily stopped up - start and end points**
  - Footpath
  - Byway

Layers: Lincolnshire County Council, 2023; Nottinghamshire County Council, 2023; North Lincolnshire County Council, 2023; Lanpro, 2023; IGR, 2023  
 Base map: reproduced from Ordnance Survey digital map data © Crown copyright 2023. All rights reserved. License number 0100031673

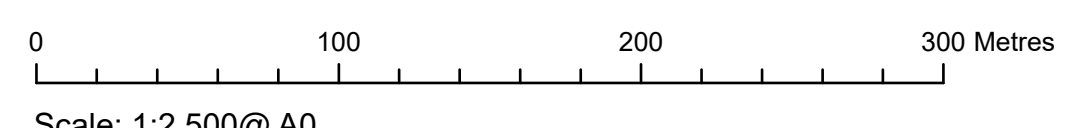

APFP Regulation: 5(2)(k)	Application Doc No. WB2.4
Ref: P2963_LPR_ZZ_ON_DR_Z_0210	Date: 07/03/2023
Drawn by: AZ	Checked by: ID

For continuation refer to sheet 9

**Public Rights of Way Plan**  
Sheet 10 of 10

**WEST BURTON SOLAR PROJECT**